

# IMPRESSA XF50 Classic



## Limpar o aparelho

Duração aproximada 15 min.

Material necessário:

**pastilha de limpeza de 2 fases**

Caixa de 25 unidades (Art. 62535)

Embalagem de 3 unidades (Art. 62715)



Este manual breve não substitui o “Manual de instruções IMPRESSA XF50”. Primeiro, leia e respeite as instruções de segurança e advertências para evitar perigos.

Pré-requisito: **PRONTO / LIMPAR**

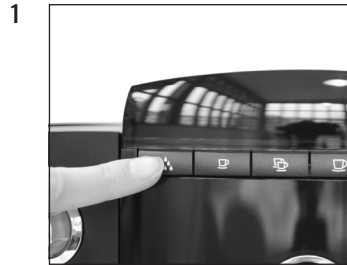

**ESVAZIAR BANDEJA**

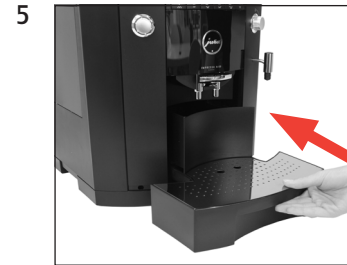
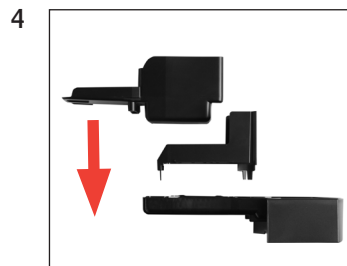
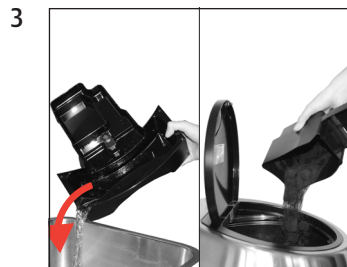

**PRESSONAR MANUTENCAO**



**LIMPA  
ADICIONAR PASTILHAS**

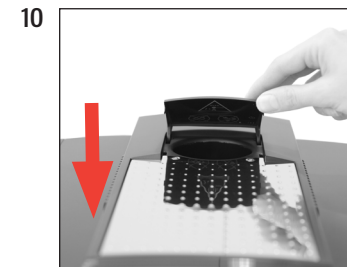
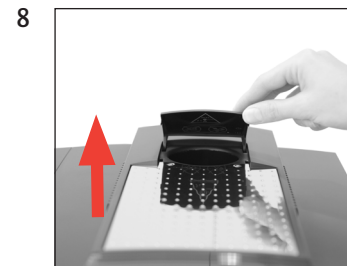

**PRESSONAR MANUTENCAO**

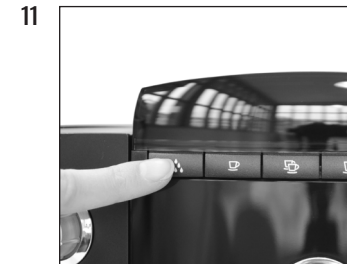

**LIMPA  
ESVAZIAR BANDEJA**

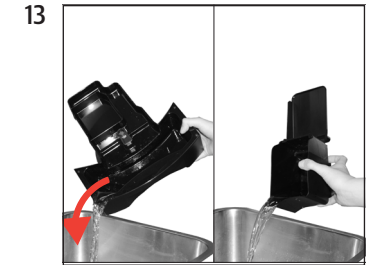
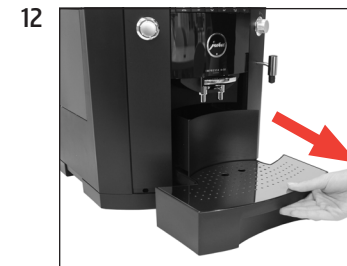

**AQUECENDO  
PRONTO**